

WESTLAND WHIRLWIND MKI INSTRUMENT PANEL

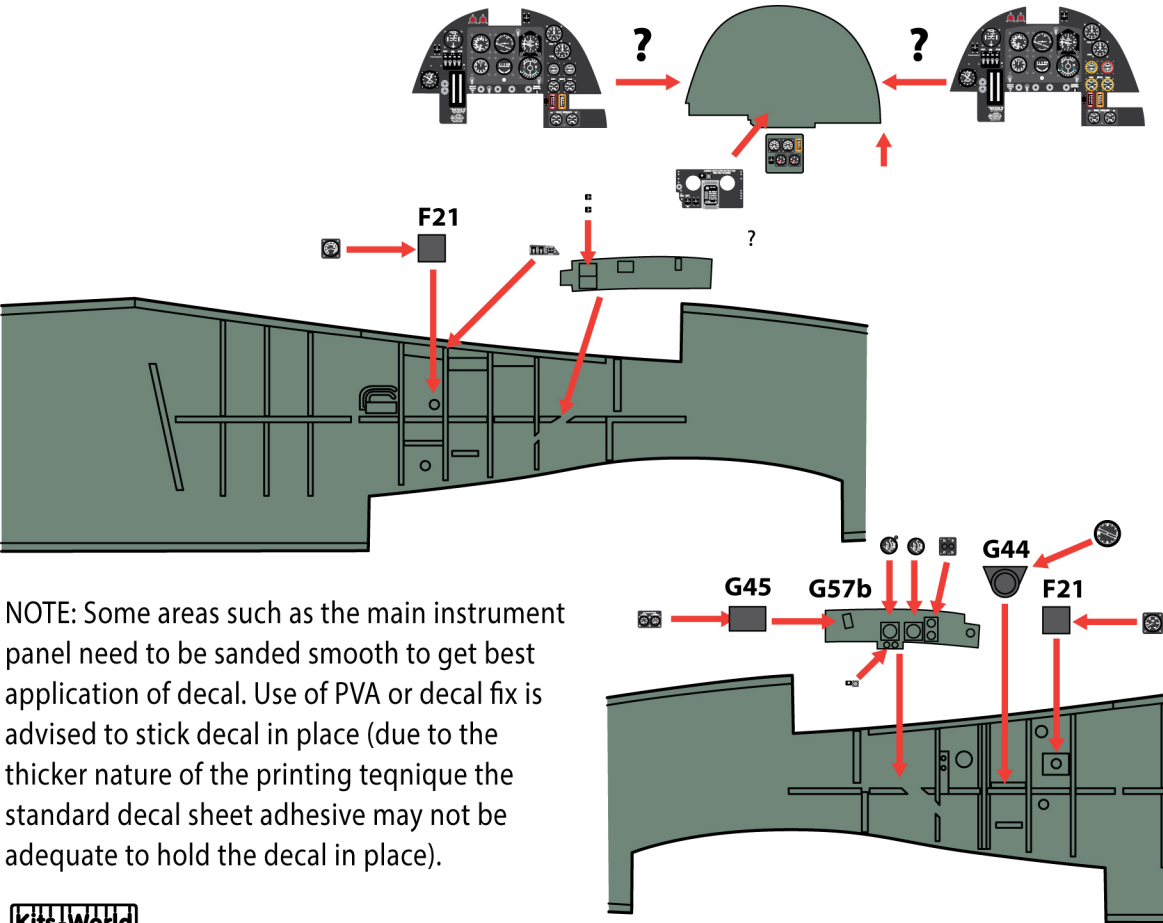

NOTE: Some areas such as the main instrument panel need to be sanded smooth to get best application of decal. Use of PVA or decal fix is advised to stick decal in place (due to the thicker nature of the printing technique the standard decal sheet adhesive may not be adequate to hold the decal in place).